

PLAN

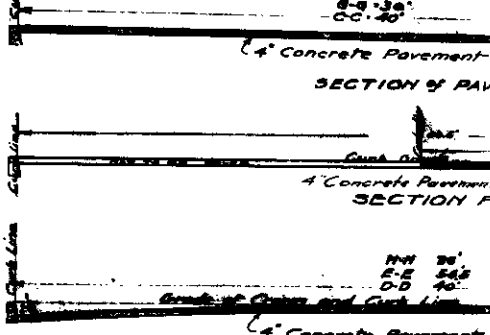
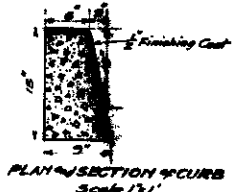
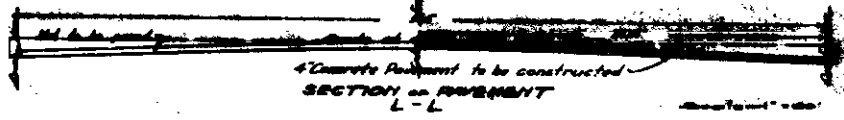
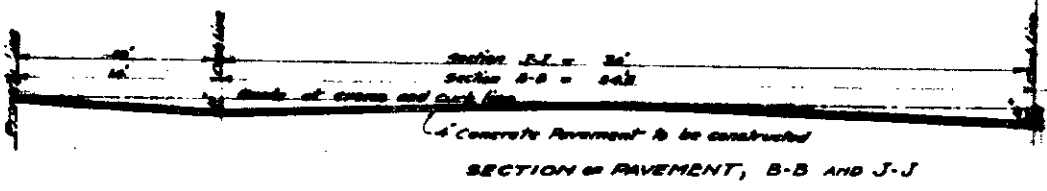
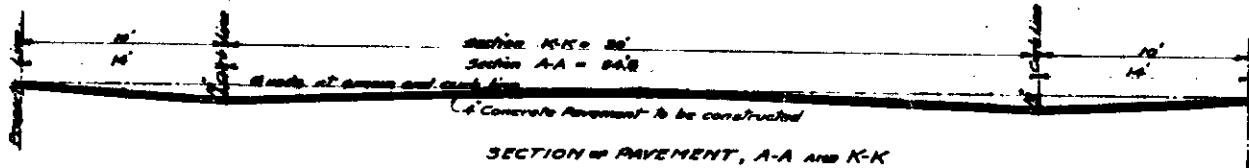

FILED

District

LEGEND
 - means inch or inches
 -' means feet or feet
 -# means number
 -E means elevation
 -A means avenue
 -St means street
 Concrete Pavement to be constructed shown thus
 Concrete Pavement in section shown thus
 Concrete Curbs in section shown thus
 Concrete Curbs to be constructed shown thus

All elevations in this plan are based upon a plane table = 1000.00 feet above the city bench mark as established by Ordinance No 585 of the City of San Bernardino, California.

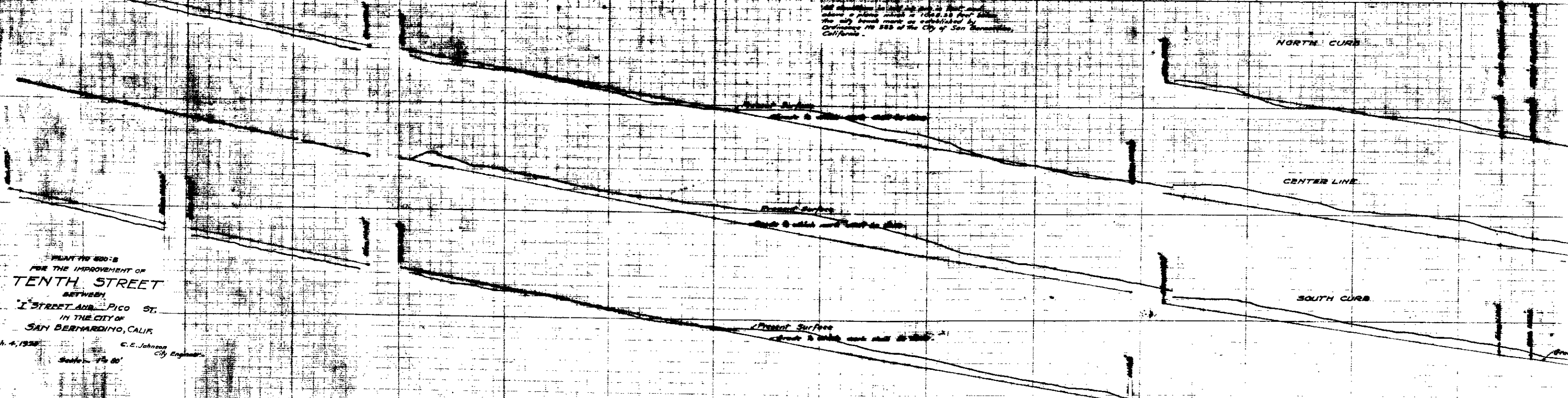

PLAN NO 520-B
 FOR THE IMPROVEMENT OF
TENTH STREET
 BETWEEN
 I STREET AND PICO ST.
 IN THE CITY OF
 SAN BERNARDINO, CALIF.

Nov. 4, 1938
 C. E. Johnson
 City Engineer

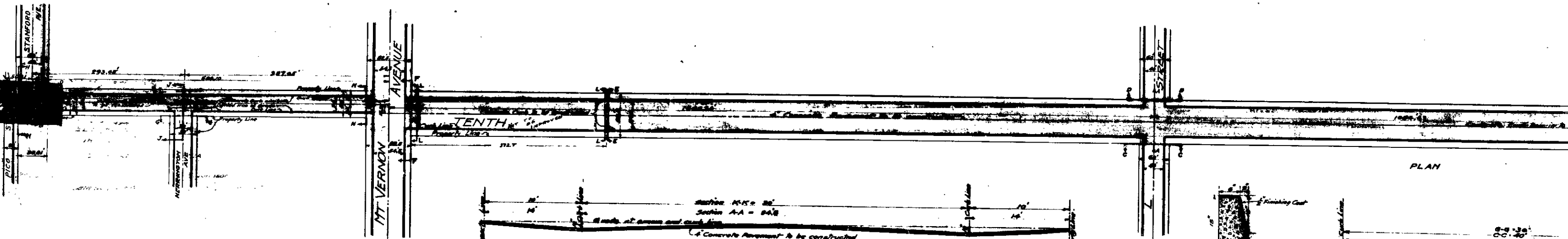

PLAN

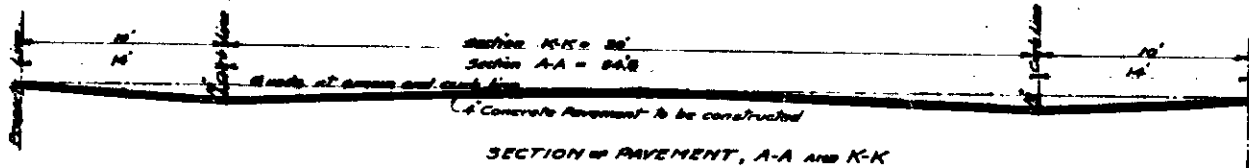

SECTION OF PAVEMENT, A-A AND K-K

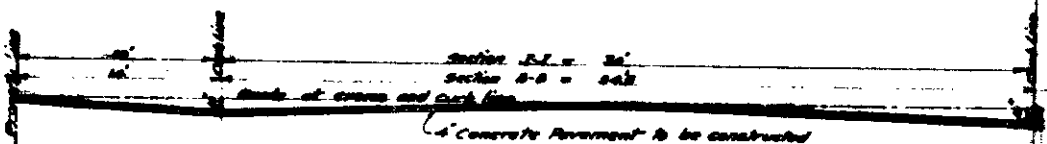

SECTION OF PAVEMENT, B-B AND J-J

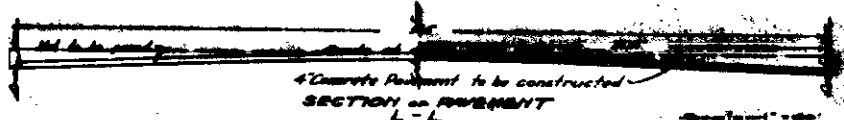

SECTION OF PAVEMENT L-L

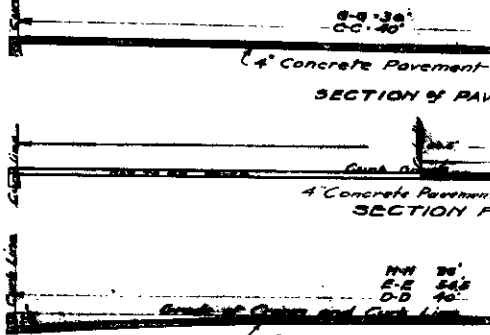
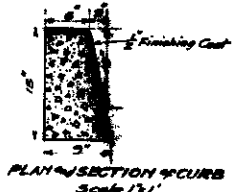

FILED

District

LEGEND
 - means inch or inches
 -' means feet or feet
 -# means number
 Elev. means elevation
 Ave. means avenue
 St. means street
 Concrete Pavement to be constructed shown thus
 Concrete Pavement in section shown thus
 Concrete Curbs in section shown thus
 Concrete Curbs to be constructed shown thus

All elevations in this plan are based on a datum of 1000.00 feet above the city bench mark as established by Ordinance No 585 of the City of San Bernardino, California.

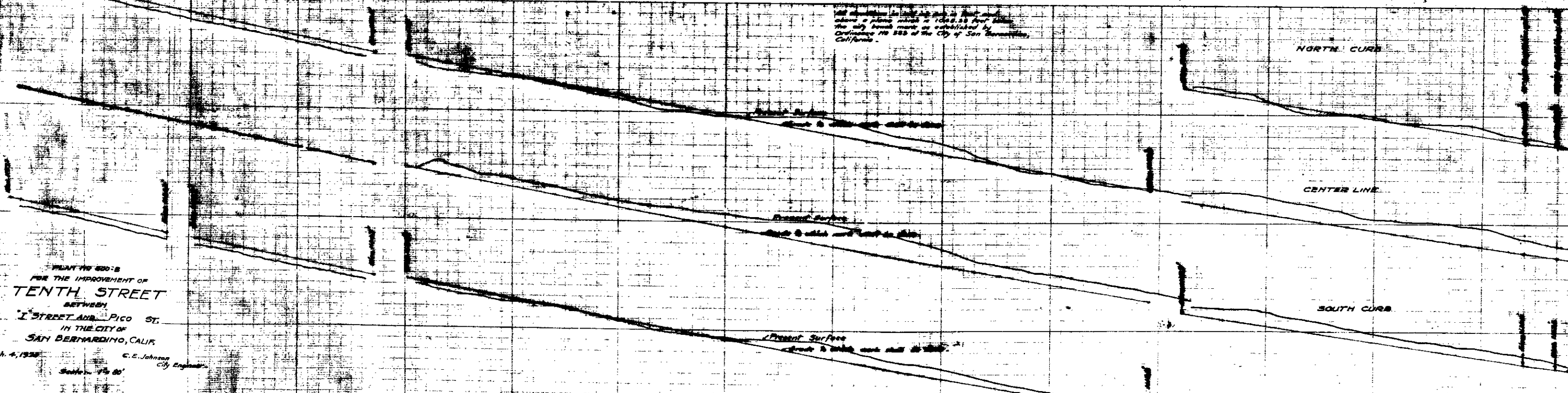

PLAN NO 520-B
 FOR THE IMPROVEMENT OF
TENTH STREET
 BETWEEN
 I STREET AND PICO ST.
 IN THE CITY OF
 SAN BERNARDINO, CALIF.

Nov. 4, 1938
 C. E. Johnson
 City Engineer